

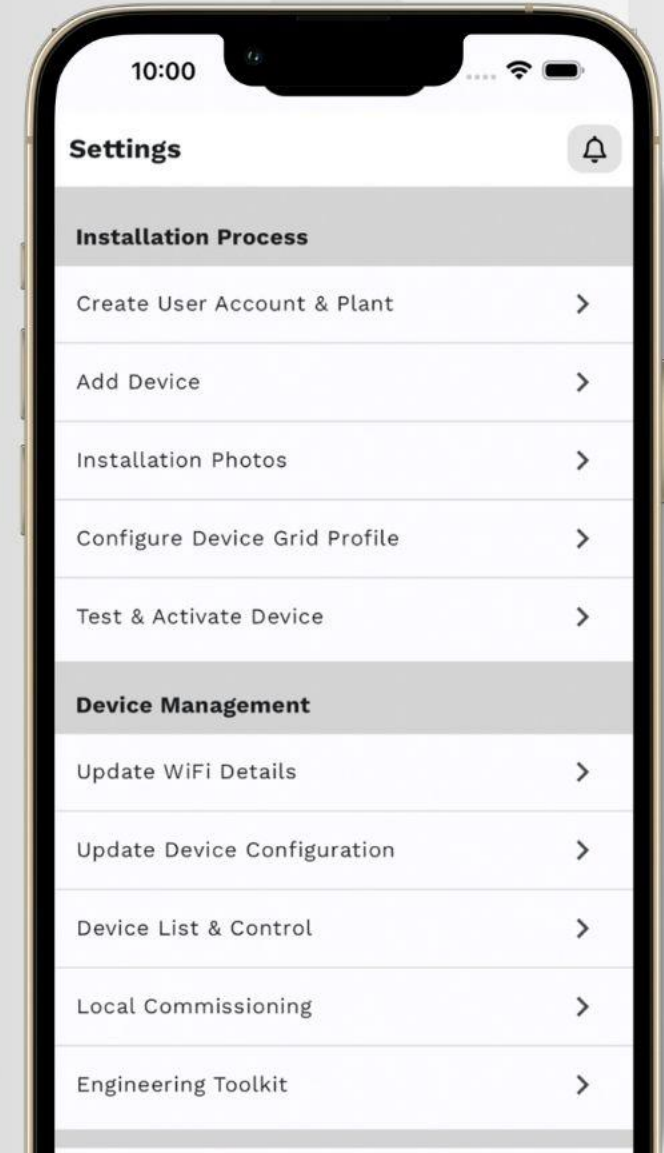

# Commissioning a Whispr system through the App

TECH SUPPORT • WHISPR

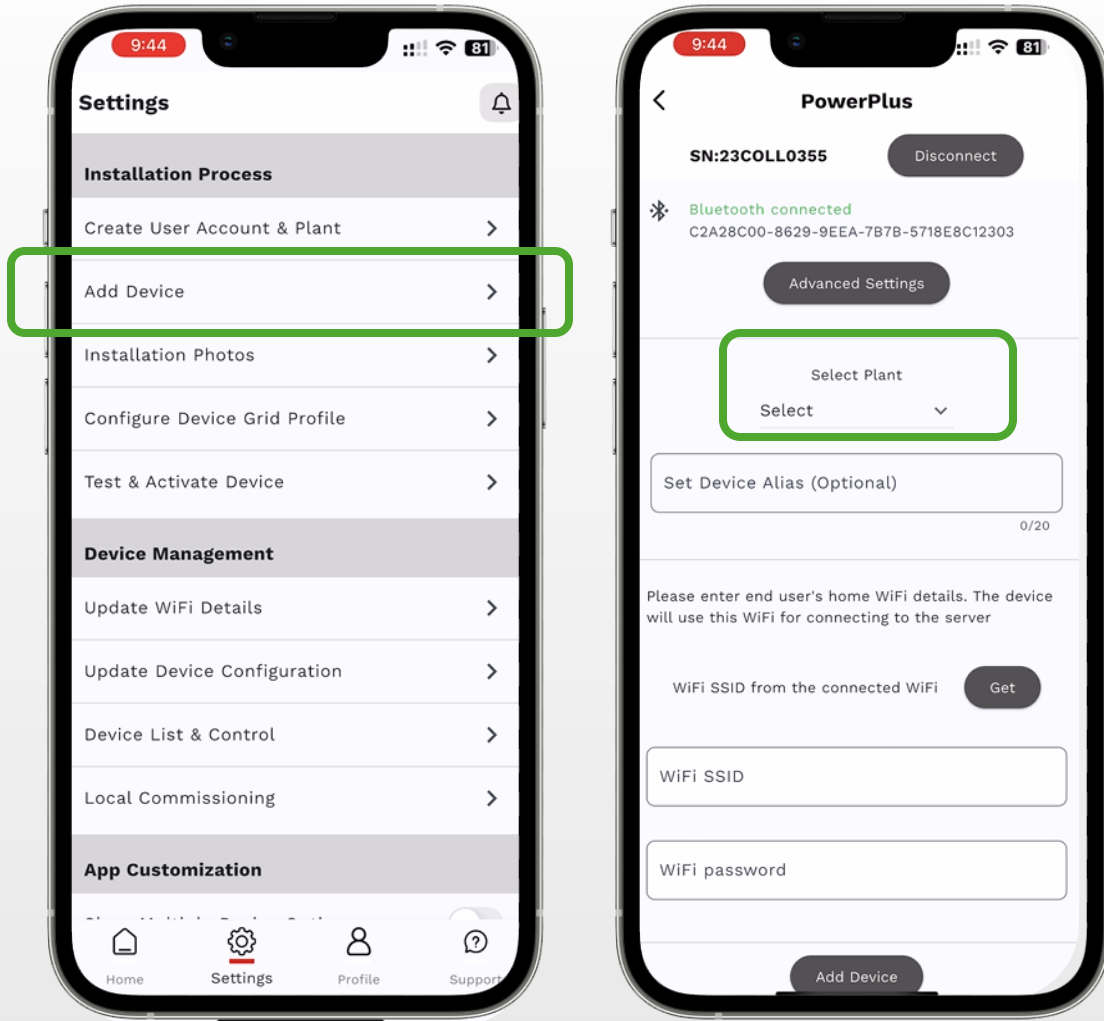



## Step 1: Add a device

- Once logged in, confirm you can see the site name in the top left corner
- Go to Settings and select 'Add Device'
- Scan the QR code on the Wi-Fi dongle (located on left-hand side of the inverter)
- Select the plant you've created for the end user to associate the device with

## Step 2: Connecting the inverter with WiFi

- Connect the inverter to the available Wi-Fi  
*We recommend connecting your phone to your end users Wi-Fi to make this process easier*
- Click 'Get' This will pick up the Wi-Fi signal your phone is connected to.
- Click on 'Add Device'
- Return to settings to add installation photos

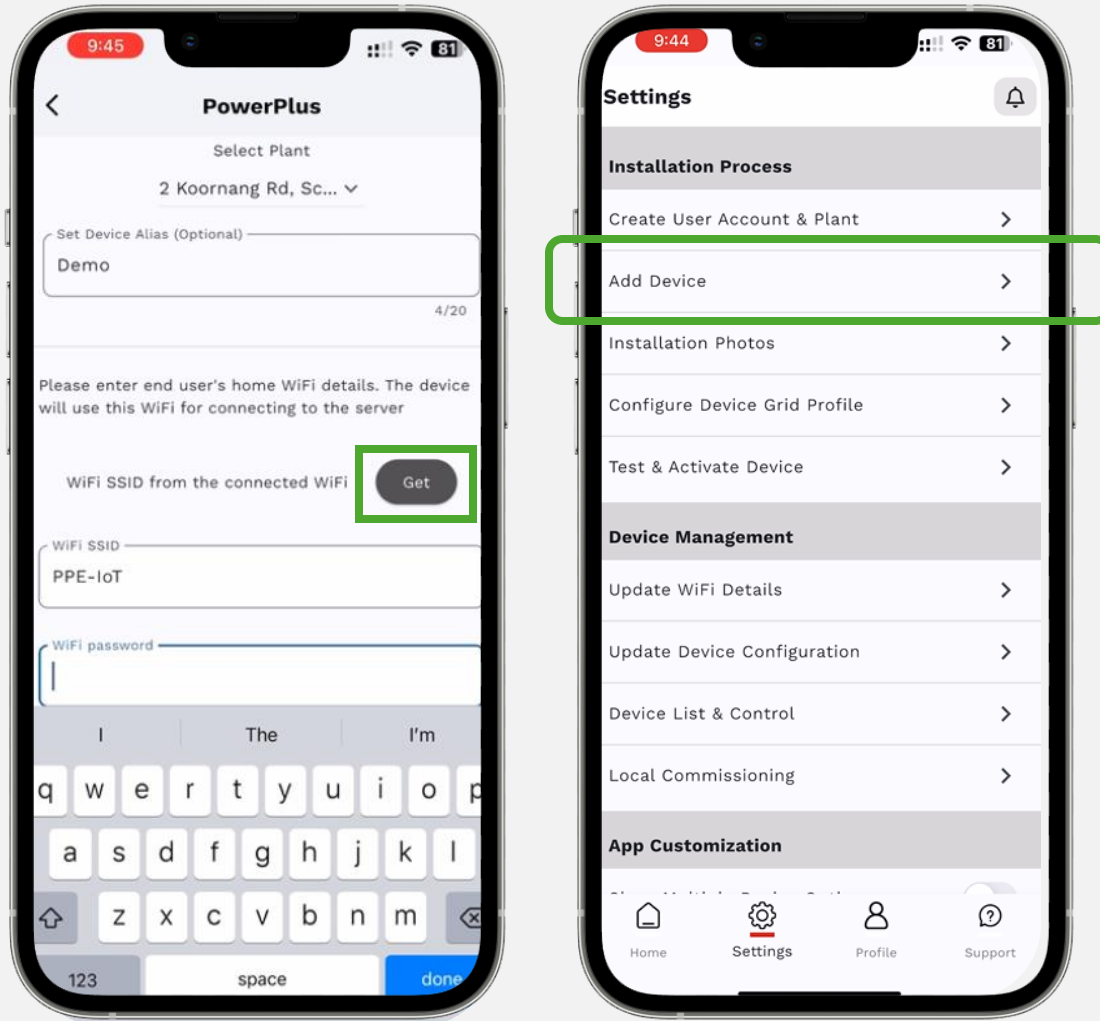

## Step 3: Adding Installation Photos

- Select 'Installation Photos' on the settings page.
- Scan the QR code.
- Take the required installation photos.
- All photos will be stored in the app and are viewable by the end user.
- Once complete go back to settings and select 'Configure Device Grid Profile' to begin commissioning.

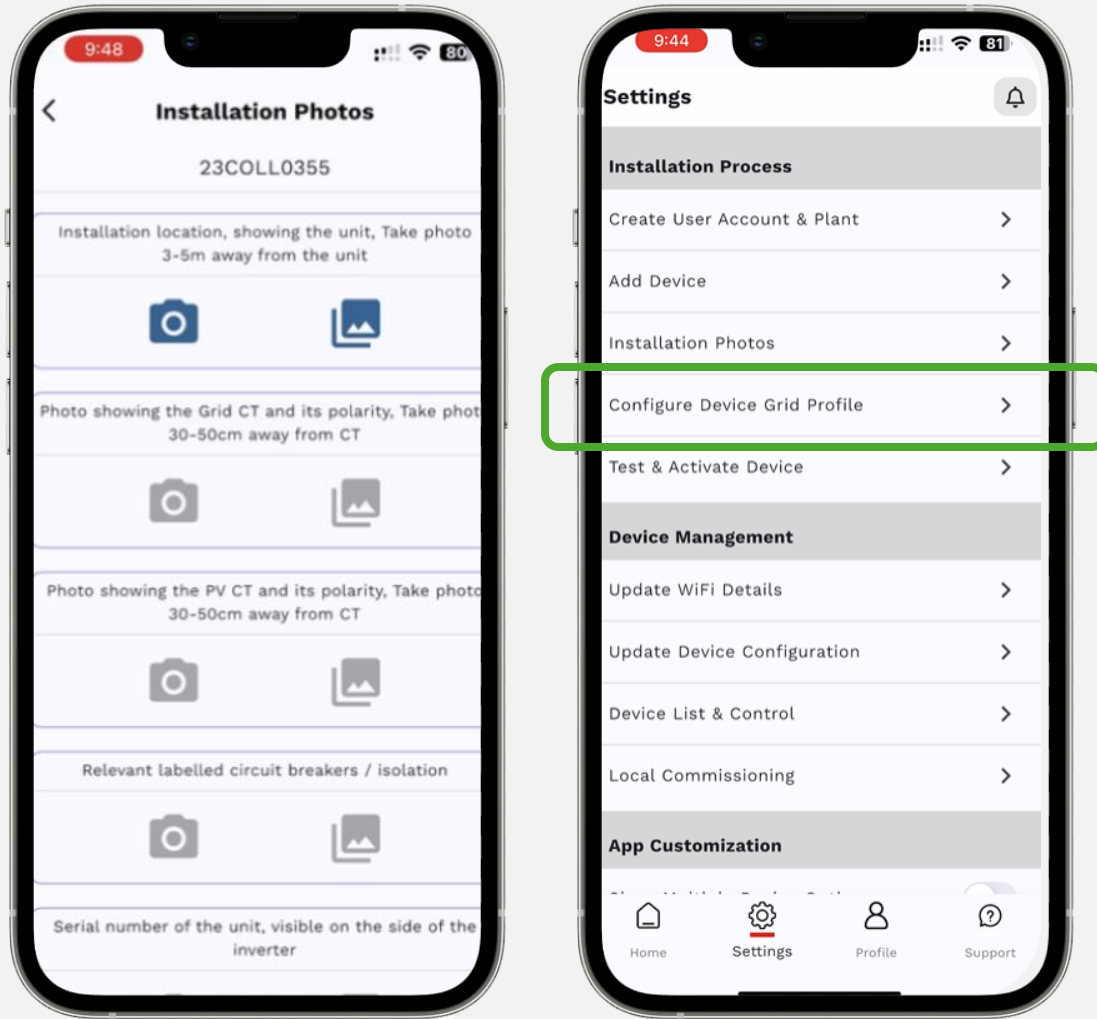

## Step 4: Configure Device Grid Profile

- To modify these settings, click on the lock and enter the system password displayed on screen
- Format: Redex@ + current date in yyyy/mm/dd
- Select the correct grid operator from the list
- Type in NMI from your end users' meter or energy bill
- Ensure the export soft limit & hard limit are set to 7000
- Click 'Save and Lock'
- After selecting the operator, the inverter will start a 60-second countdown to power up.

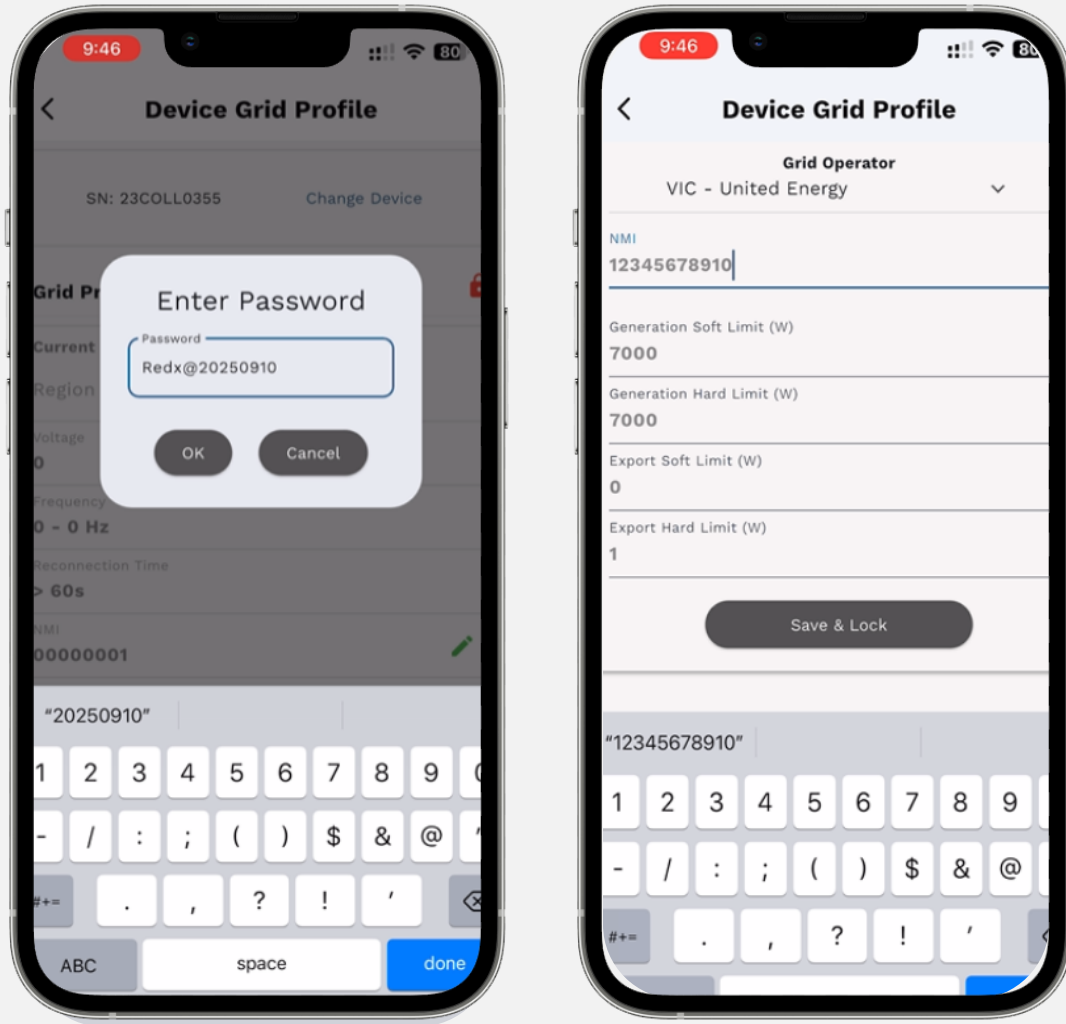

## Step 4: Configure Device Grid Profile cont.

- You can still modify the NMI as it is an editable option
- In Victoria CSIP should be seen as pending
- LFDI number generated, for Victoria residents this is not relevant
- Relevant for Jemena
- For some DSPs you will need to copy and share' this number yourself
- Device is now commissioned for your region
- Return to settings and click on Device list and Control to double check device will work as needed.

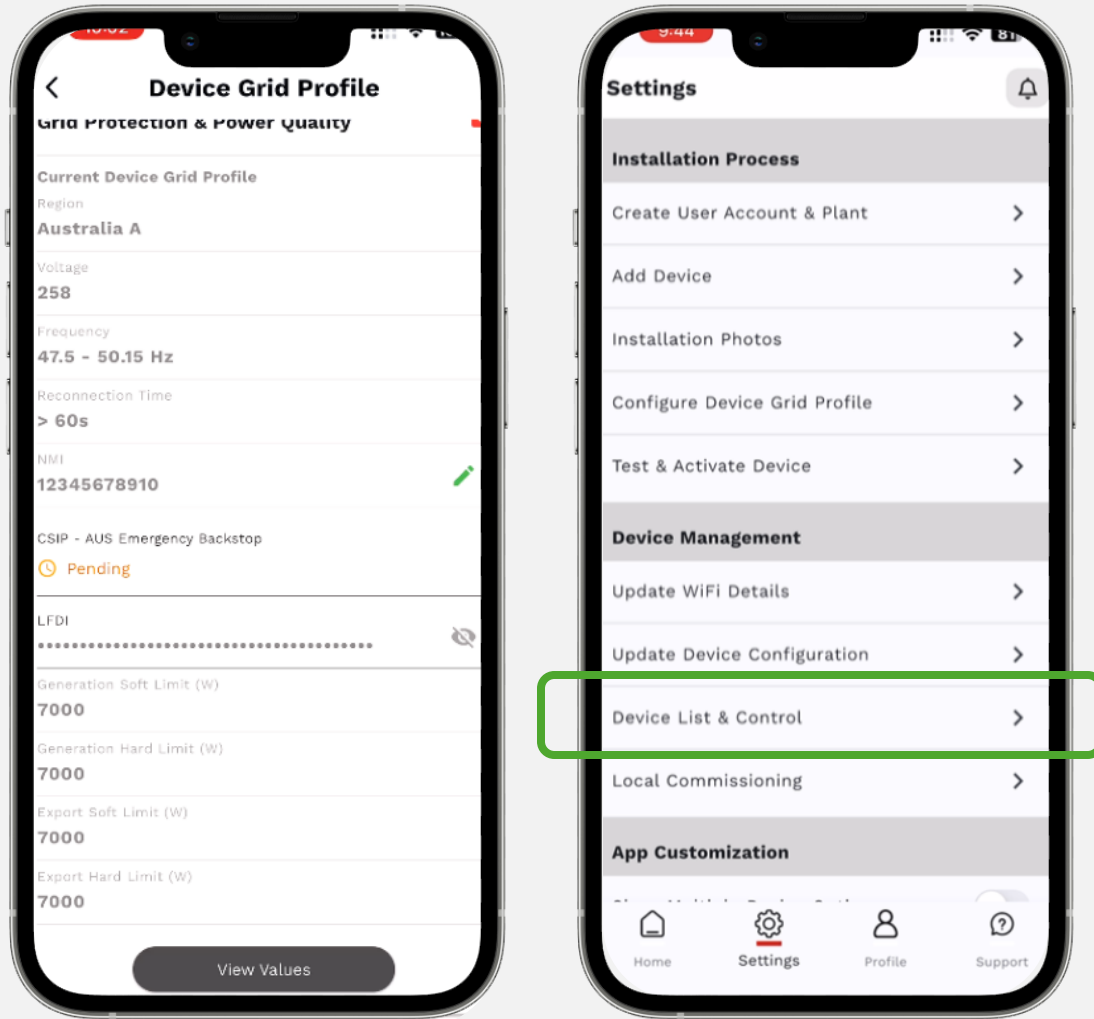

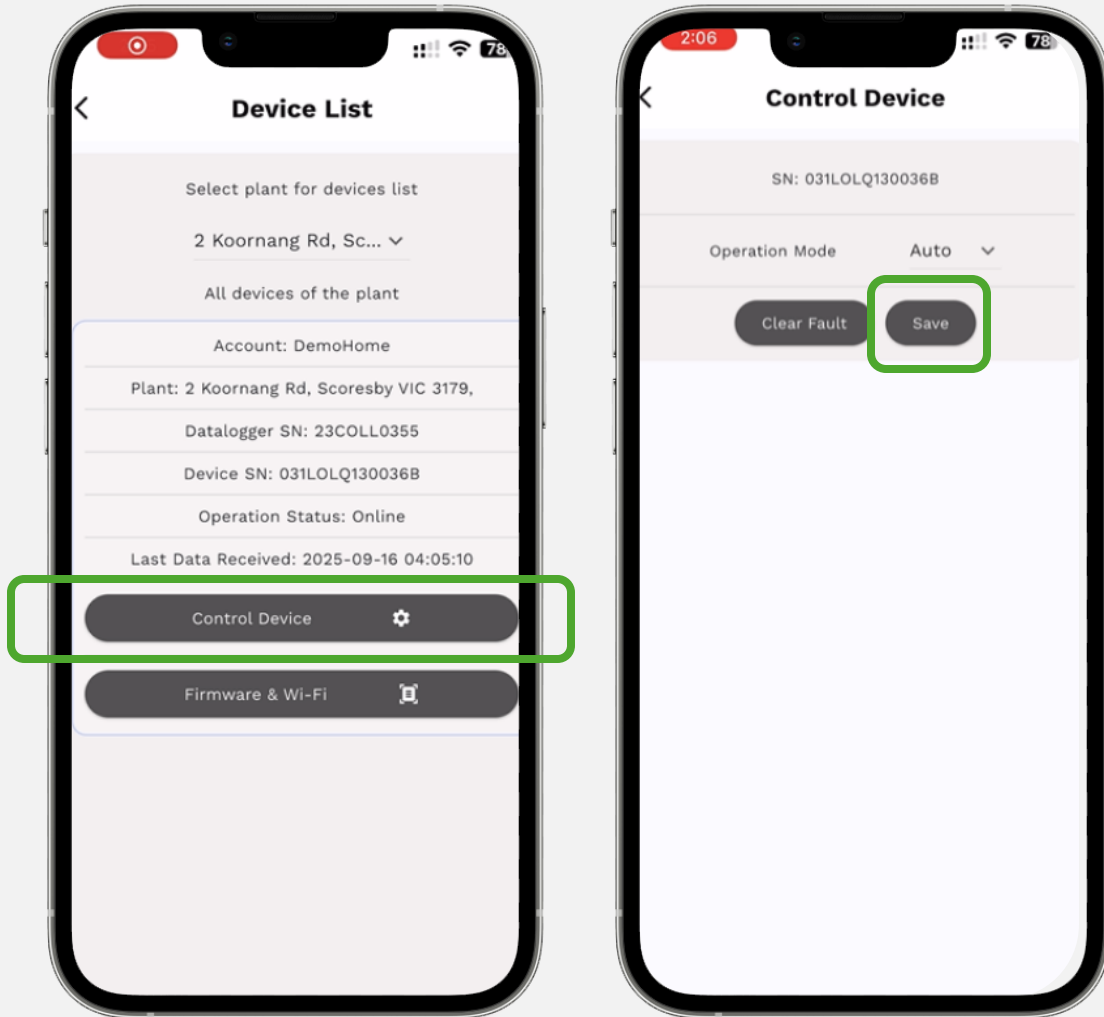

## Step 5: Finalising the commissioning

- Check operation status is showing online
- Click on 'Control Device'
- Standard operation mode should be Auto, if this is not showing please change.
- This will set the system to self-consumption
- Click 'Save'
- Your system is now fully commissioned
- Please remember to register for warranty.



**PowerPlus Energy Pty Ltd**

2 Koornang Road

Scoresby, Vic, 3179

Australia

+61 3 8797 5557

[info@powerplus-energy.com.au](mailto:info@powerplus-energy.com.au)

[powerplus-energy.com.au](http://powerplus-energy.com.au)